

SCUBAPRO

Technical Service Schematic

MK 15 FIRST STAGE #10-600-000

Date 12/97 Revision B
Annual Repair Parts Kit #10-600-041

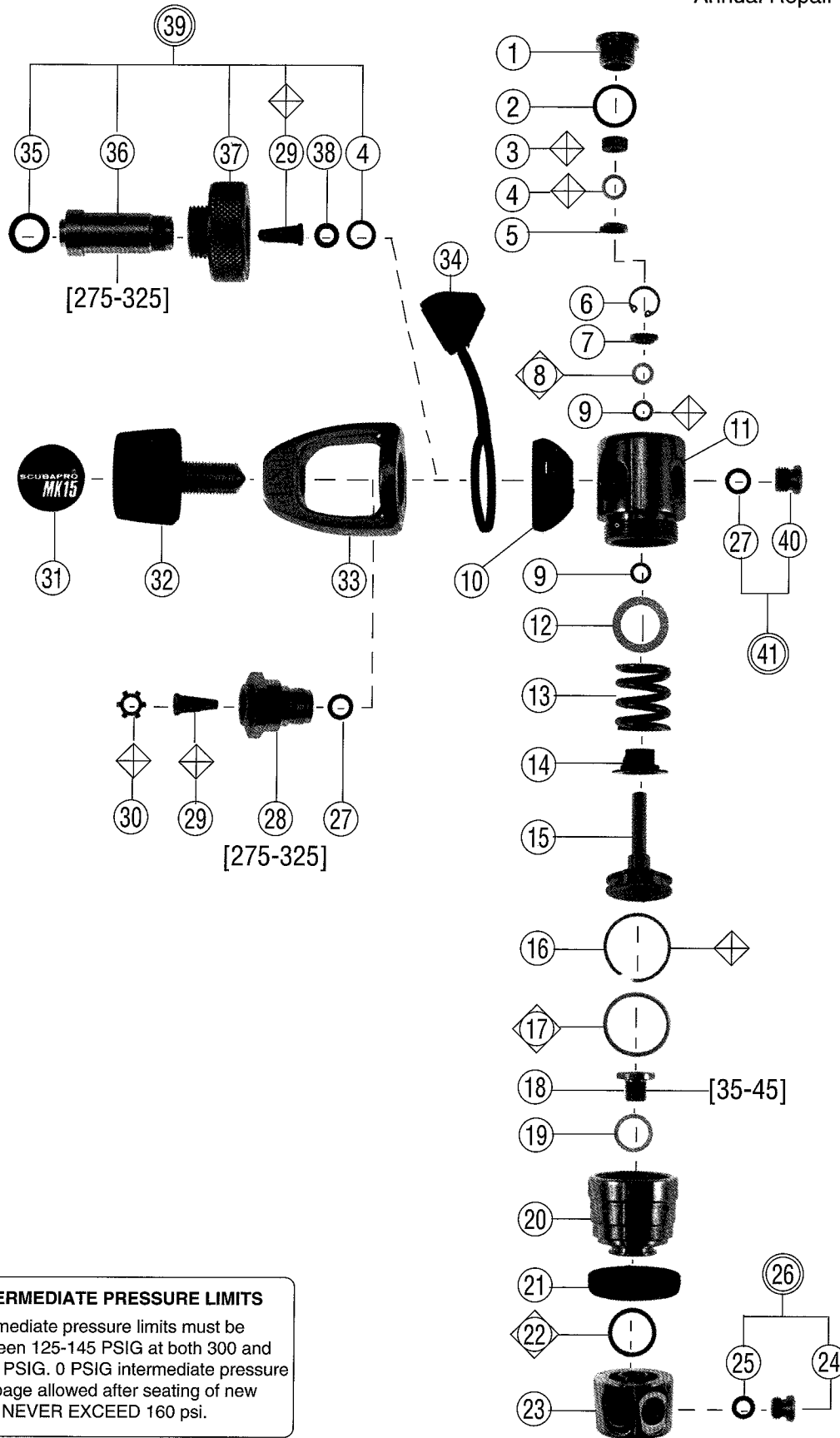

INTERMEDIATE PRESSURE LIMITS

Intermediate pressure limits must be between 125-145 PSIG at both 300 and 3000 PSIG. 0 PSIG intermediate pressure creepage allowed after seating of new seat. NEVER EXCEED 160 psi.

SCUBAPRO

Technical Service Schematic

MK 15 FIRST STAGE 10-600-000

Date 12/97 Revision B
Annual Repair Parts Kit #10-600-041

Parts

| # | QTY | PART # | DESCRIPTION | COST |
|-------|-----|------------|------------------------------------|------|
| * 1 | 1 | 10-600-125 | RETAINER, SEAT, HP | |
| 2 | 1 | 01-050-398 | O-RING, SEAT RETAINER, BLACK | |
| * 3 | 1 | 10-600-123 | SEAT, HP | |
| * 4 | 1 | 01-050-401 | O-RING, SEAT, AMBER | |
| 5 | 1 | 10-600-124 | INSERT BUSHING, CHROME | |
| 6 | 1 | 01-073-112 | RETAINING RING, O-RING, COPPER | |
| 7 | 1 | 10-600-129 | WASHER, RING, RETAINING | |
| 8 | 1 | 01-050-137 | O-RING, PISTON, SHAFT, AMBER | |
| * 9 | 2 | 01-060-600 | WASHER, O-RING | |
| 10 | 1 | 10-600-111 | SADDLE, MK15 | |
| 11 | 1 | 10-600-101 | BODY, MK15 | |
| * 12 | 1 | 01-060-218 | WASHER, SHIM, MK15 | |
| 13 | 1 | 01-020-600 | SPRING, MK15 | |
| 14 | 1 | 10-600-115 | SLEEVE, PLASTIC, MK15 | |
| 15 | 1 | 10-600-103 | PISTON, MK15 | |
| 16 | 1 | 01-051-222 | RING, BACK-UP | |
| 17 | 1 | 01-050-179 | O-RING, PISTON, LARGE, AMBER | |
| 18 | 1 | 10-500-103 | RETAINER, SWIVEL | |
| 19 | 1 | 01-060-500 | WASHER, SWIVEL | |
| 20 | 1 | 10-600-102 | CAP, SWIVEL, MK15 | |
| 21 | 1 | 10-600-114 | TRIM BUMPER, SWIVEL, MK15 | |
| 22 | 1 | 01-050-161 | O-RING, SWIVEL | |
| 23 | 1 | 10-600-118 | SWIVEL, MK 15 | |
| 24 | 4 | 10-101-104 | PLUG, LP, (3/8-24) | |
| 25 | 4 | 01-050-132 | O-RING, LP PLUG, BLUE | |
| 26 | 4 | 10-101-006 | PLUG, LP, (3/8-24) WITH O-RING | |
| 27 | 1 | 01-050-138 | O-RING, HP PLUG & YOKE RTNR, BLUE | |
| 28 | 1 | 10-600-104 | RETAINER, YOKE, MK15 | |
| 29 | 1 | 01-028-109 | FILTER | |
| 30 | 1 | 01-073-101 | RETAINER | |
| 31 | 1 | 01-006-623 | DECAL, YOKE SCREW, MK15 | |
| 32 | 1 | 10-200-008 | YOKE SCREW ASSEMBLY | |
| 33 | 1 | 10-101-157 | YOKE, MACHINED, SATIN FINISH | |
| 34 | 1 | 10-101-211 | HP, PROTECTOR, COMBO YOKE/DIN | |
| 35 | 1 | 01-050-193 | O-RING, DIN, BLACK | |
| 36 | 1 | 10-400-107 | RETAINER, DIN, 300 BAR | |
| 37 | 1 | 10-105-118 | KNOB, DIN, 300 BAR | |
| 38 | 1 | 01-060-501 | WASHER, DIN | |
| ○ 39 | 1 | 10-400-030 | KIT, DIN, 300 BAR | |
| 40 | 1 | 10-101-139 | PLUG, HP, (7/16-20) | |
| 41 | 1 | 10-101-039 | HP PLUG WITH O-RING (7/16-20) | |
| ○ ● 1 | 1 | 10-600-119 | SPEC BOOT, MK15 | |
| ○ ● 1 | 1 | 10-600-020 | SPEC KIT, W/BOOT & SILICONE GREASE | |
| * ● 1 | 1 | 10-600-051 | MK15 UPGRADE KIT | |

Technical Information:

ALLEN WRENCH SIZES:

- #28 yoke retainer 5/16 or 8mm
- #24 LP Plug 5/32
- #40 HP Plug 5/32
- #36 Din retainer 15/32 or 6mm

Item #13 note: 01-020-601 spring (red) may be used if lower intermediate pressures are required.

Special Engineering Notes:

Flow through piston designs will under some conditions make a whistling noise during flow. To alleviate, heavily lubricate Item #8, 01-050-137 and/or replace item #3, 10-600-123 HP seat.

Reference Item #1 If MK15 HP seat retainer has the Allen Hex 8mm inset, install Upgrade Kit #10-600-051. (See Engineering Bulletins #234).

Reference Item #12: A maximum of 3 washers (#10-060-218) may be used to adjust intermediate pressure to specified limits.

Legend (prices subject to change without notice)

- Not Shown ◇ Dynamic O'Ring Replace Annually
- Optional Item ◇ Annual Replacement
- ▲ Limited Warranty [] Torque In Inch Pounds
- Older Configuration * See Note